

Detail système  
de fixation  
Ech 1:1

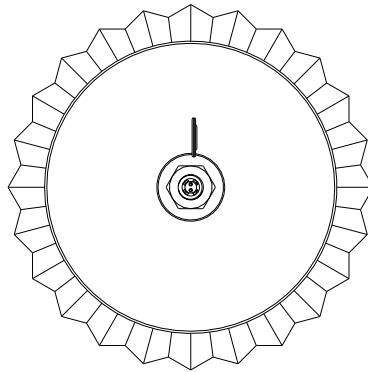
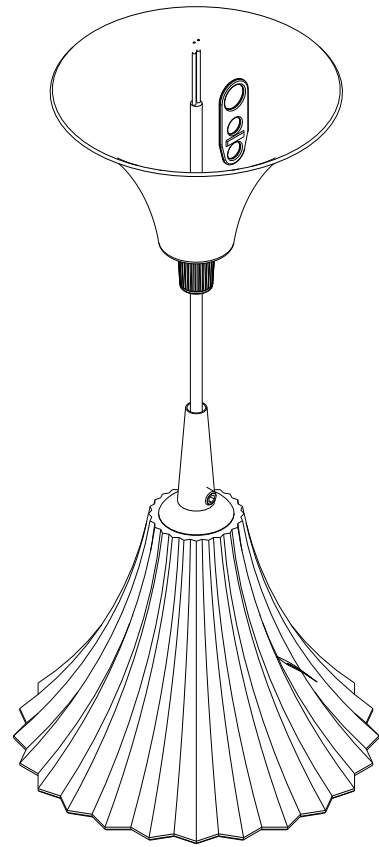
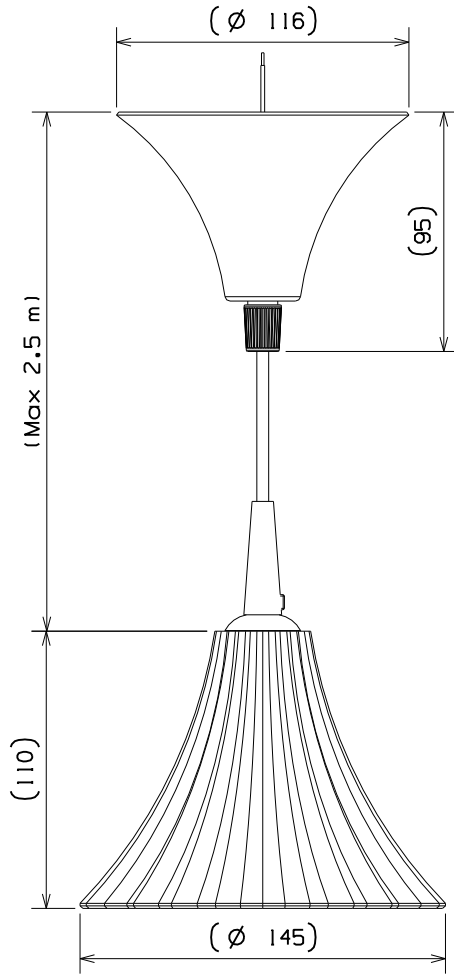
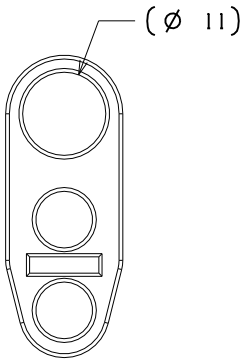

*Baccarat*  
**MILLE NUITS**  
MILN-SUSPENSION JET  
Serie 01

25W  
100-127V~ 50/60Hz  
- G9 1 X MAX 25W

IP20  
ta: 25°C

Manufactured by *Baccarat*  
54120 Baccarat FRANCE

Code	Designation	Couleur
2104903	SUSP JET MILLE NUIT	CCL
2104906	SUSP JET MILLE NUIT	ROUGE
2104909	SUSP JET MILLE NUIT	AMBRE
2104917	SUSP JET MILLE NUIT	PIVOINE
2105814	SUSP JET MILLE NUIT	BLEU
2105817	SUSP JET MILLE NUIT	VERTE
2606406	SUSP JET MILLE NUIT	CCL OR

Ech.  
Scale: 1/3

A4

POIDS / WEIGHT: 1 kg env.

DATE: 17.12.10

FOLIO: 1/1

*Baccarat*

Siege Social et Manufacture / Head Office and Factory :  
20, rue des cristalleries - 54120 BACCARAT  
Tel. +33 (0)3 83 76 60 06 Telecopie +33 (0)3 83 76 60 04

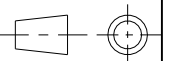

PLAN D'ENSEMBLE  
GLOBAL DRAWING:

Mothios

NUMERO PLAN / DRAWING NUMBER:

MILN-SUSPENSION JET  
"Mille Nuits"

143098